

MARKING SCHEME

GHS

GEOGRAPHY
TIME: 1 Hour

S.1
APRIL 2012

1. (a) **Definition of Geography**
Geography is the study of man and his environment/ Is the study of the physical and human environment. (2 marks)
- (b) **Sources of geographical information**
- Text books
 - Maps and Atlases
 - Print media/press/newspapers/magazines/journal etc.
 - Television
 - Radio
 - Internet
 - Knowledgeable persons
 -
- Any 5 x 1 = (5 marks)*
2. (a) **Places where Gayaza High School is situated**
- (i) **Region** – Central/Buganda (1 mark)
- (ii) **District** – Wakiso (1 mark)
- (iii) **County** – Kyadondo (1 mark)
- (iv) **Sub-county** – Nangabo (1 mark)
- (v) **Parish** – Gayaza (1 mark)
- (b) **Description of the site of Gayaza High School**
- It is sited on a flat topped ridge with gentle slopes.
 - It lies at an average height of 3,800 feet
- 2 x 1 = (2 marks)*
3. (a) **What a map is**
A map is a representation of an area or feature drawn as seen from above. (2 marks)
- (b) **Types of Geographical maps**
- Physical maps
 - Political maps
 - Climatic maps
 - Land use/Economic maps
 - Geological maps
 - Soil maps
 - Vegetation maps
 - Population maps
- Any 5 x 1 = (5 marks)*

4. A sketch map of 1x classroom showing the main features

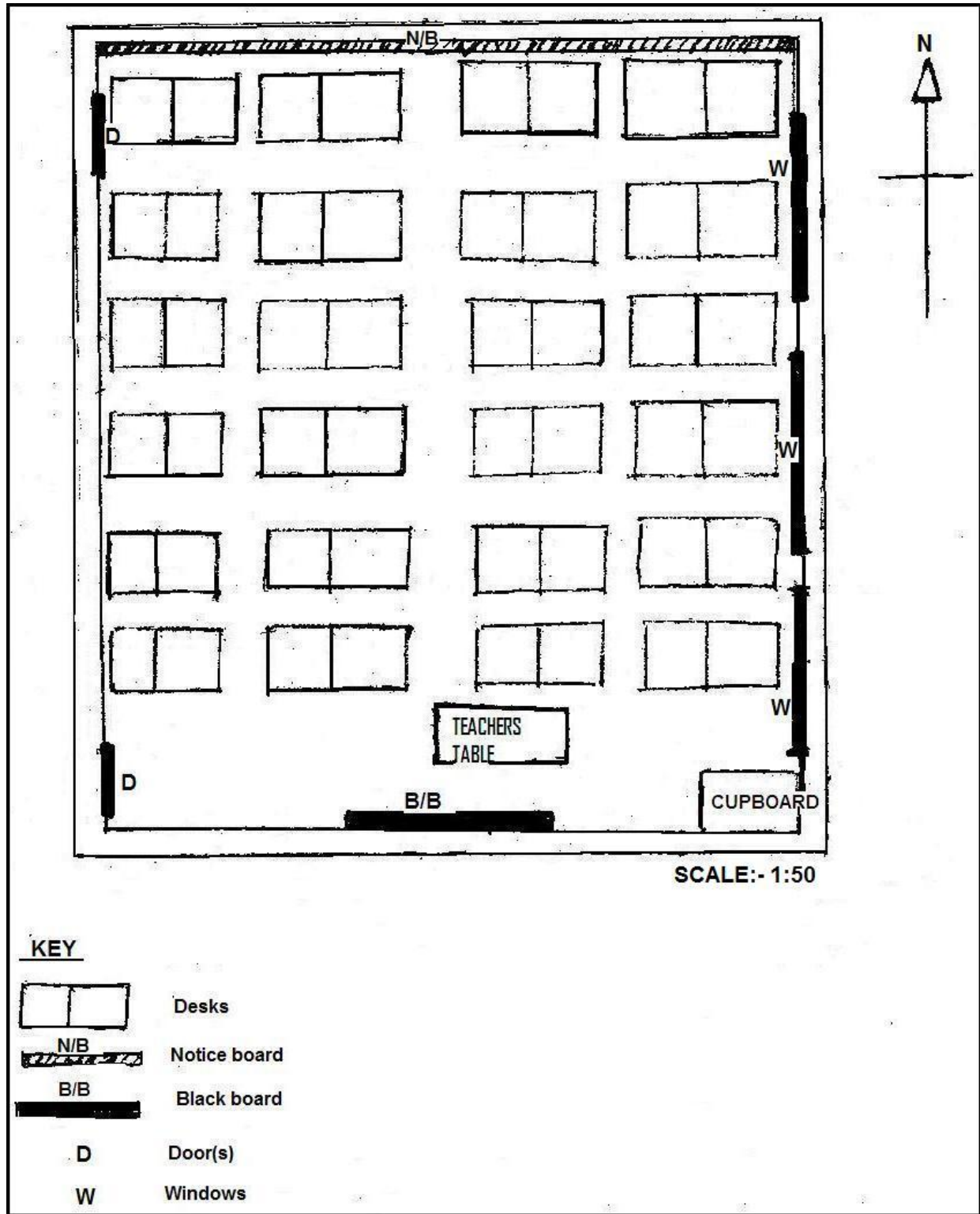

Mark allocation:

Marginal information:

- Complete/descriptive title (1 mark)
- Correct compass direction (1 mark)
- Complete enclosing frame (1 mark)
- Key/labeling (1 mark)
- Correct scale (1 mark)

Features:

- Desks/tables (1 mark)
- Black board (1 mark)
- Notice board (1 mark)
- Windows (1 mark)
- Doors (1 mark)
- Cupboard (1 mark)

5. (a) **Types of landforms found in Uganda**
Hills, Valleys, Ridges, Mountains, Plains, Plateaus, Escarpments, Basins, Beaches, Cliffs, Slopes, Passes, Gorges, Knolls, Caves, fault scarps, Inselbergs, Cols, Saddles, etc.

Any 5 x 1 = (5 marks)

- (b) **Cities found in East Africa**

- Kampala
- Nairobi
- Dar es Salaam
- Mombasa
- Kisumu
- Dodoma
- Arusha
-

Any 5 x 1 = (5 marks)

6. (a) **Countries bordering Uganda in the:**

- (i) **North** – South Sudan (1 mark)
- (ii) **East** – Kenya (1 mark)
- (iii) **West** – Democratic Republic of Congo (1 mark)
- (iv) **South** – Tanzania (1 mark)

- (b) **Naming the:**

- (i) **Deepest lake in Uganda** – Lake Bunyonyi (1 mark)
- (ii) **Longest river in the world** – River Nile (1 mark)
- (iii) **Highest point/mountain in the world**
– Mount Everest (1 mark)
- (iv) **Deepest point/ocean trench in the world**
– Mariana Trench (1 mark)